

## 6. Front Ball Joint

### A: REMOVAL

- 1) Lift up the vehicle, and then remove the front wheels.
- 2) Remove the bolts and clips, and remove the under cover - front.

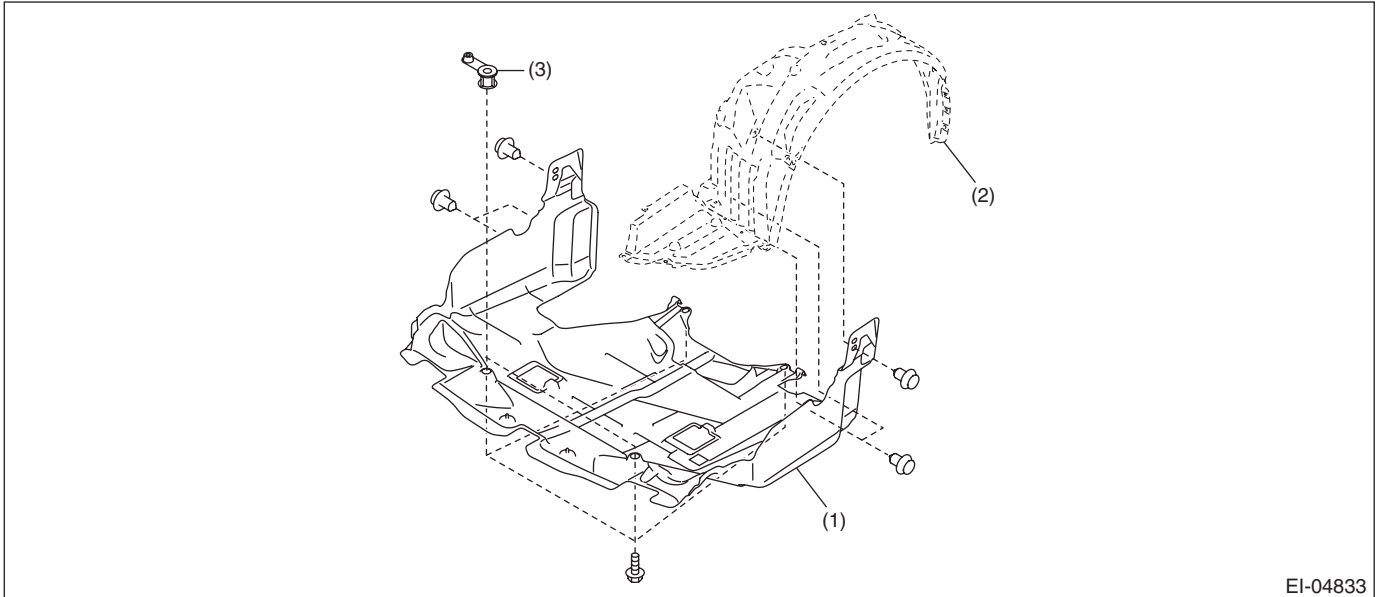

EI-04833

(1) Under cover - front

(2) Mud guard - front

(3) Plate cover - rear (XV model)

- 3) Remove the clamp - stabilizer bushing on the left and right sides.

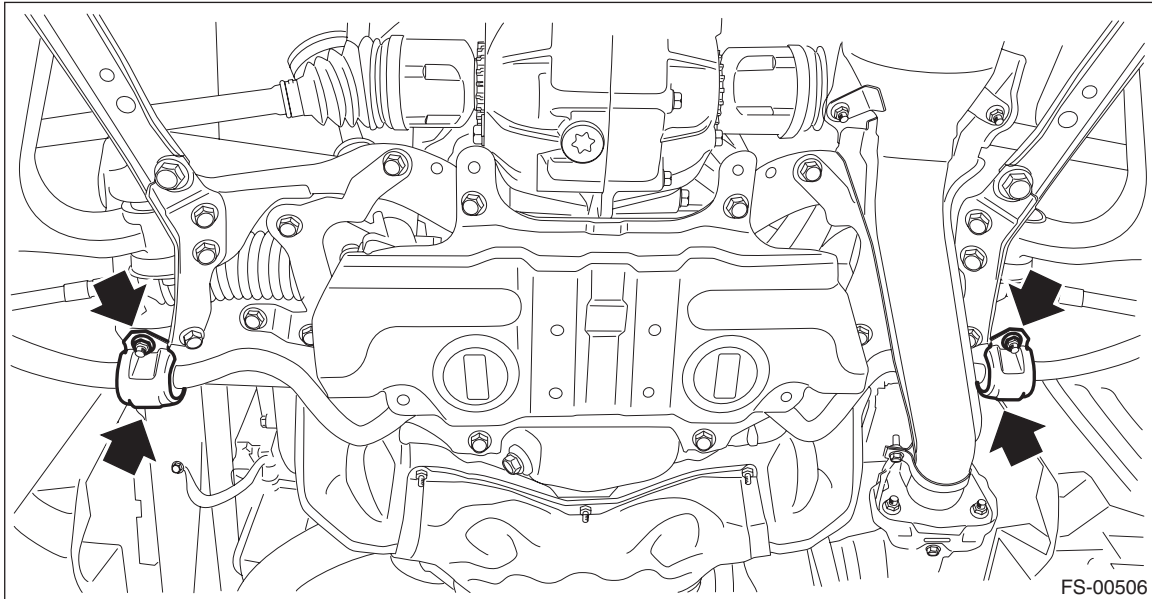

FS-00506

# Front Ball Joint

## FRONT SUSPENSION

4) Remove the ball joint assembly.

- (1) Pull out the cotter pin (a), and remove the castle nut (b).
- (2) Lower the front arm assembly, and remove the ball stud.
- (3) Remove the bolt from the housing assembly - front axle.

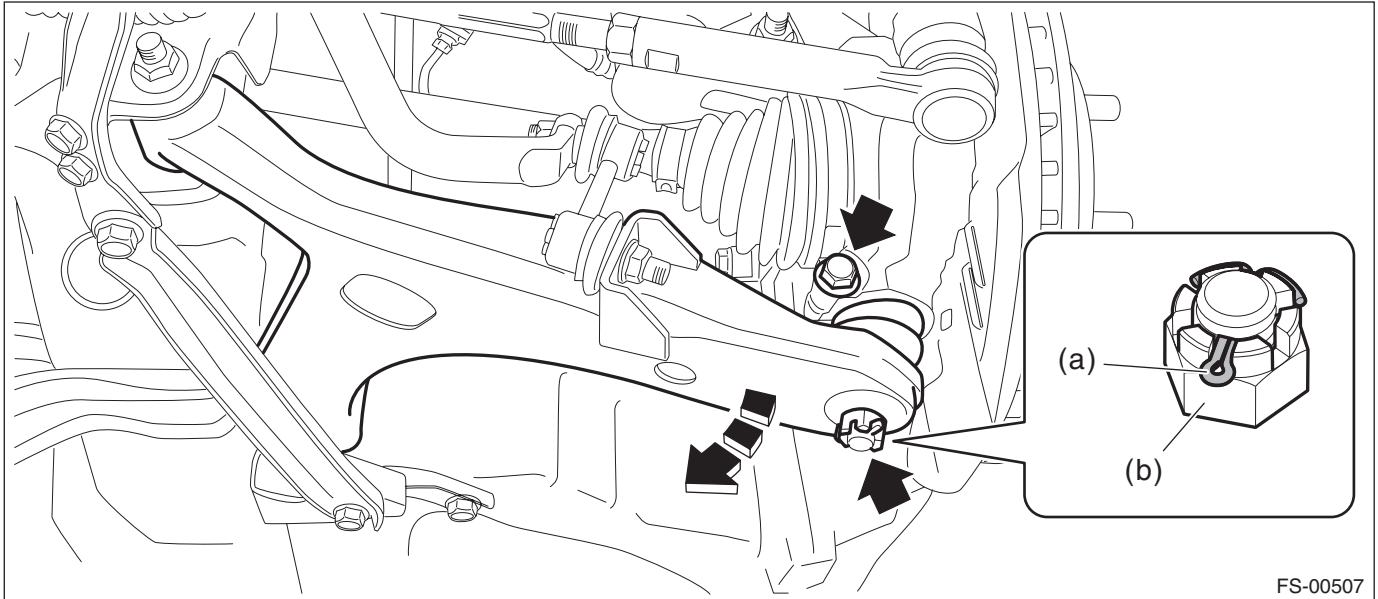

(4) Extract the ball joint assembly from the housing assembly - front axle.

## B: INSTALLATION

1) Install the ball joint assembly to the housing assembly - front axle.

### CAUTION:

- Do not apply grease to the tapered portion of ball stud.
- Before tightening, make sure the bottom surface of the housing assembly - front axle and the stepped section of ball joint are in contact.

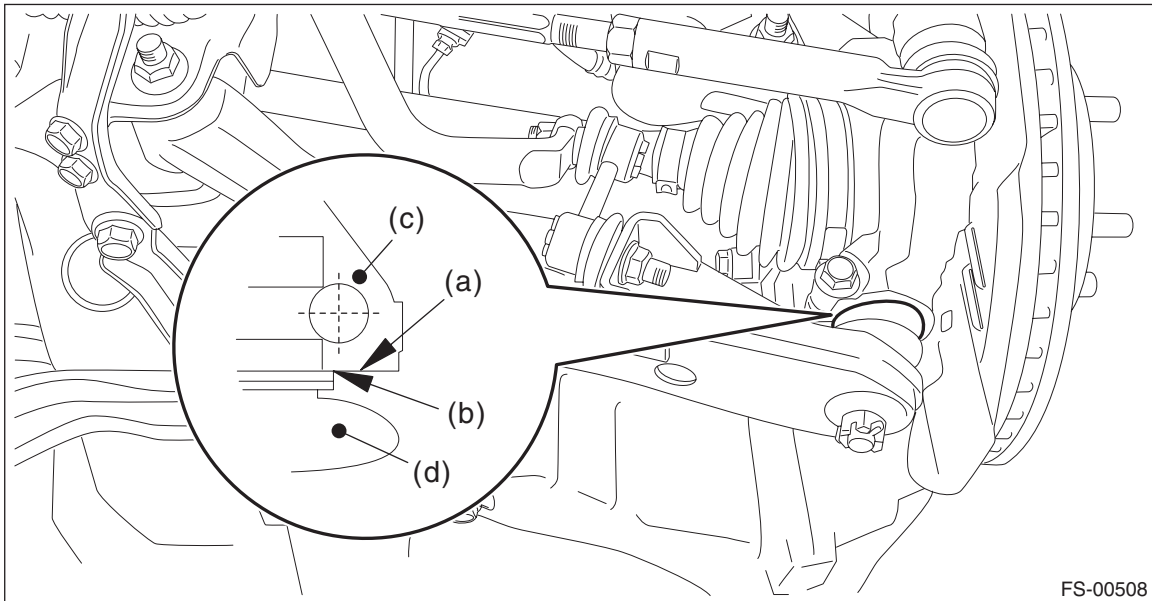

(a) Bottom surface of housing ASSY - front axle

(c) Housing ASSY - front axle

(d) Ball joint ASSY

(b) Raised section of ball joint

### Tightening torque:

**50 N·m (5.10 kgf-m, 36.9 ft-lb)**

- 2) Install the ball joint assembly to the front arm assembly.
  - (1) Connect the ball joint assembly to the front arm assembly.

**Tightening torque:**

**39 N·m (3.98 kgf-m, 28.8 ft-lb)**

- (2) Retighten the castle nut further up to 60° until the hole in the ball stud is aligned with a slot in castle nut.
  - (3) Insert a new cotter pin and bend it around the castle nut.
- 3) Install the clamp - stabilizer bushing.

**CAUTION:**

**Install the clamp - stabilizer bushing with the arrow mark facing the front of the vehicle.**

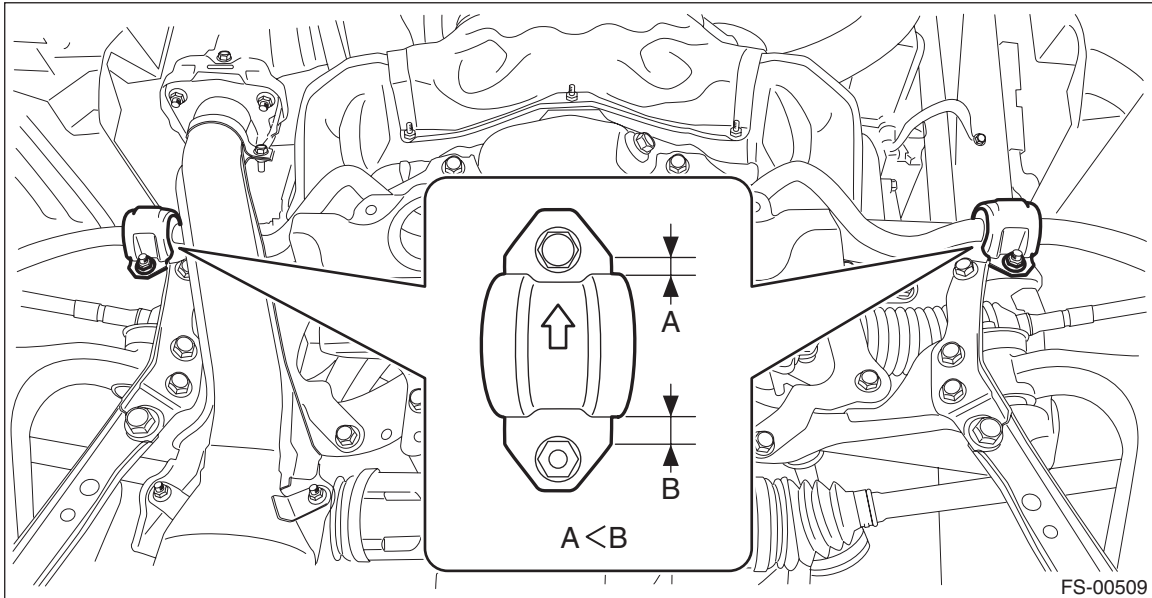

**Tightening torque:**

**25 N·m (2.55 kgf-m, 18.4 ft-lb)**

- 4) Install the under cover - front.

**CAUTION:**

**Install the under cover so that the under cover front end (b) comes inside of the bumper face - front (a).**

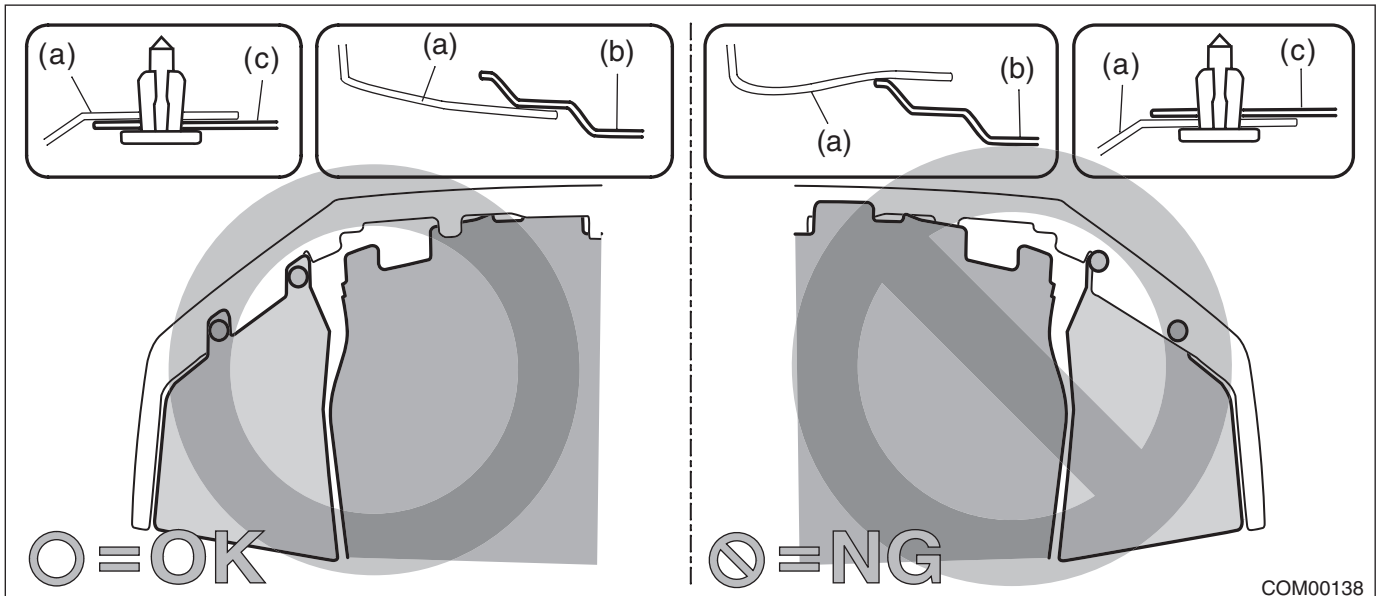

## Front Ball Joint

### FRONT SUSPENSION

---

#### **Tightening torque:**

**18 N·m (1.84 kgf-m, 13.3 ft-lb)**

5) Install the front wheels.

#### **Tightening torque:**

**Except for C4 model: 120 N·m (12.24 kgf-m, 88.5 ft-lb)**

**C4 model: 100 N·m (10.20 kgf-m, 73.8 ft-lb)**

### **C: INSPECTION**

1) Check that there is no play by moving the upper and lower portions of front tire in an axial direction with the brake pedal depressed.

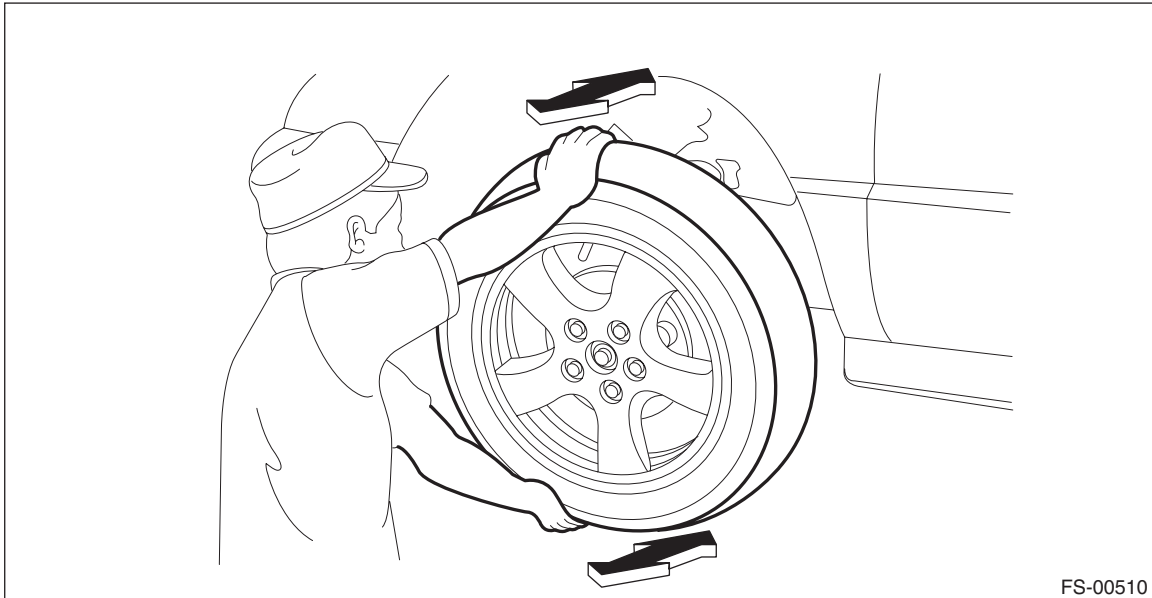

- **Play exists.** → Replace the ball joint assembly. <Ref. to FS-33, REMOVAL, Front Ball Joint.>
- 2) Check that there is no play by moving the upper and lower portions of front tire in an axial direction with the brake pedal released.
- **Play exists.** → Check the hub unit COMPL - front axle. <Ref. to DS-33, INSPECTION, Front Hub Unit Bearing.>
- 3) Replace the ball joint assembly if the dust cover is damaged when visually inspecting the dust cover.